

# ALPI

Swing gate operator

## ALP-200

Instructions Manual

Rev. 1

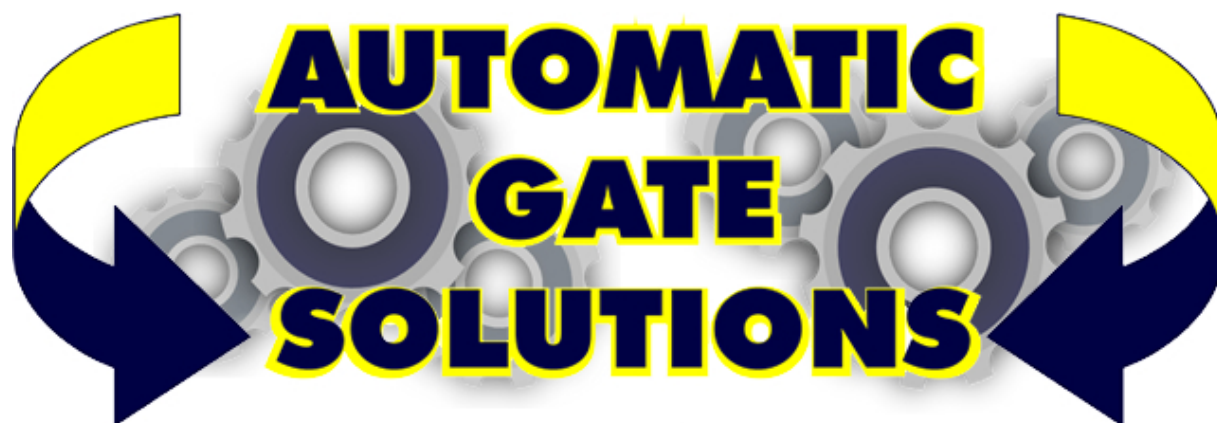
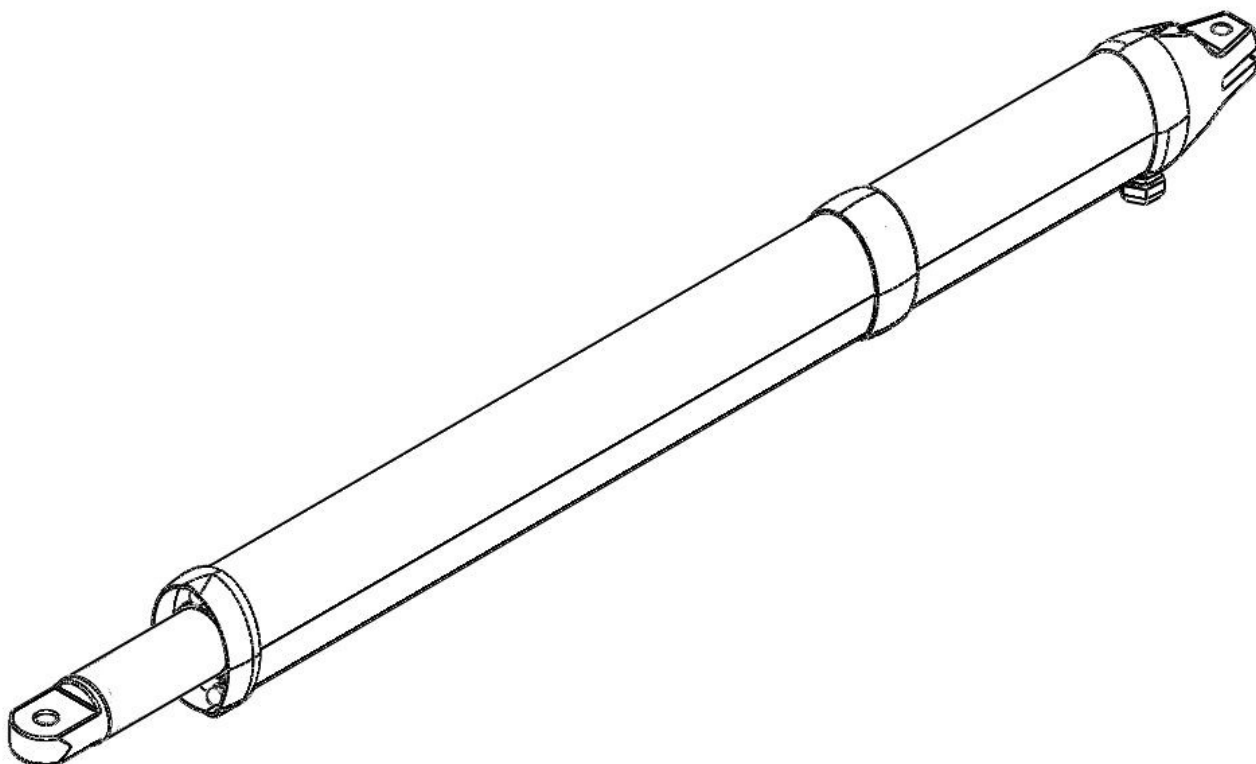

[www.automaticgatesolutions.com.au](http://www.automaticgatesolutions.com.au)



GB

**Important:** Read carefully this manual before the installation. This manual is integral part of your product, keep it for reference.

**Warnings:** First of all verify that this product is suitable for the installation. Read carefully technical characteristic before the installation (kind of gate, max allowed wing weight and length, etc). Be sure the gate satisfies all requirements of quality, robustness and stability.

Installation of this automatism must be properly done by qualified installers, following rules and regulations of installation country.

It's mandatory do periodic maintenance each 6 month. Maintenance or repairing must be done by qualified Technicians. Turn power off before maintenance or repairing.

This device is intended for gate automation, any other applications is strongly advised.

Not respecting of rules may cause serious damage to peoples, animals, things. Manufacturer discharges all responsibility for missed respect of rules.

Don't let remotes or gate controls unattended or where children can reach

## Technical characteristics

Power Supply	24Vdc
Motor power	25W
Current consumption	1A
Max thrust	1000N
Operating temperature range	-20 +60°C
IP Protection	IP44
Duty	50%
Weight	4kg

## Wiring

Motors wiring	4x2mm <sup>2</sup>
Blinker wiring	2x2mm <sup>2</sup>
Control unit supply	3x1.5mm <sup>2</sup>

**Before installing:** Read carefully this instruction manual and verify following points.

Pillars supporting your gate must be solid and stable. Verify your gate, must be in good state, correctly installed and balanced, it must open easily and without friction points. If gate has friction points, installer must remove it before to install the automation, otherwise installation couldn't work properly.

Provide a free space close to the gate for maintenance and manual unlock.

Verify that wing's weight and length doesn't exceed what mentioned in the technical characteristics in this manual.

## Limits of use

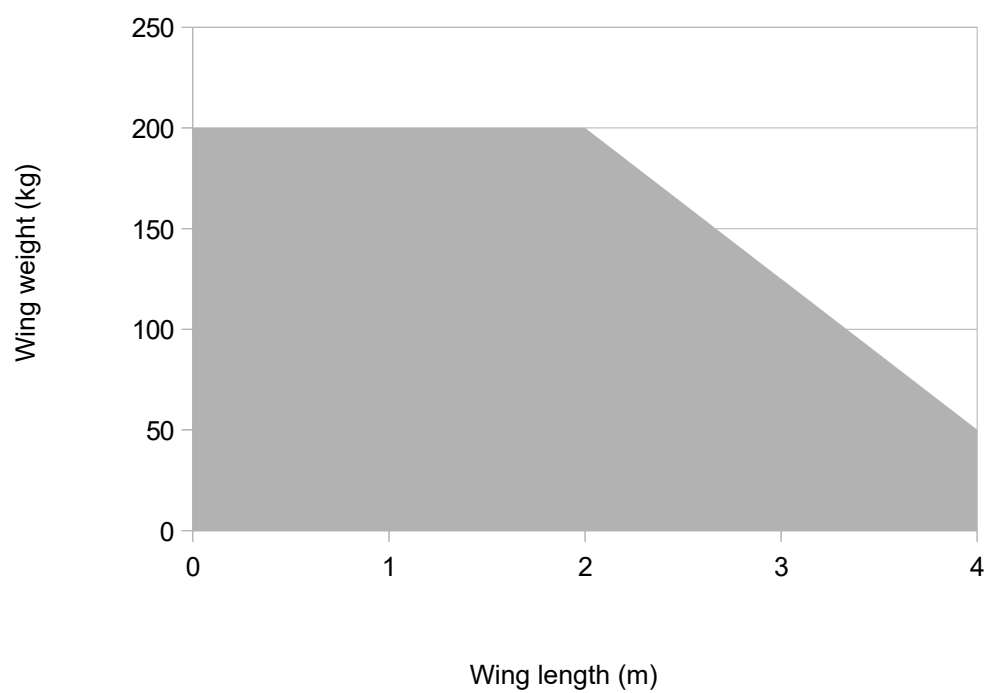

## Dimensions

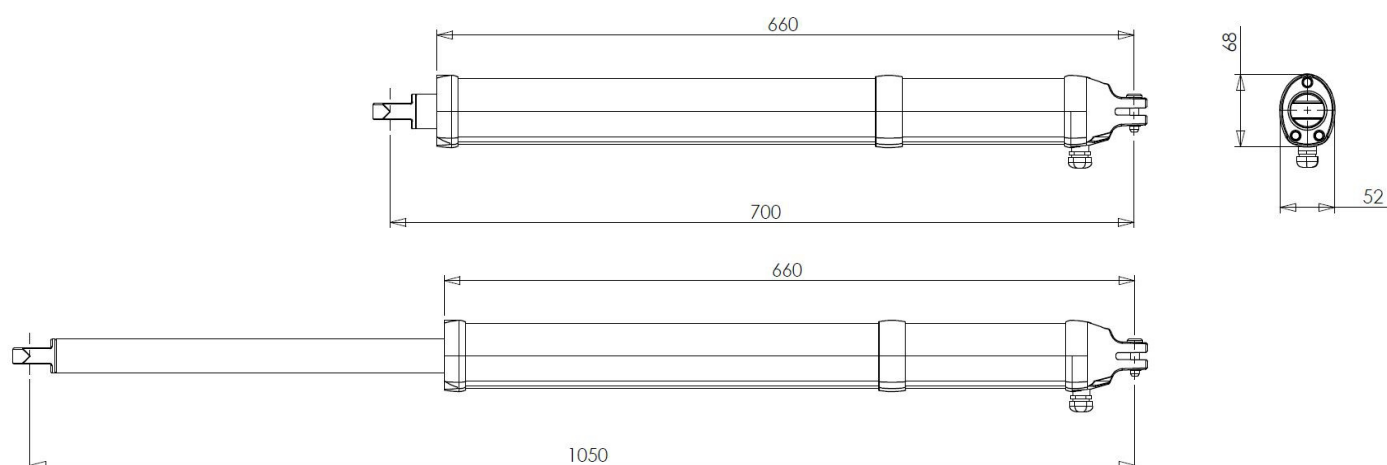

# Installation dimension

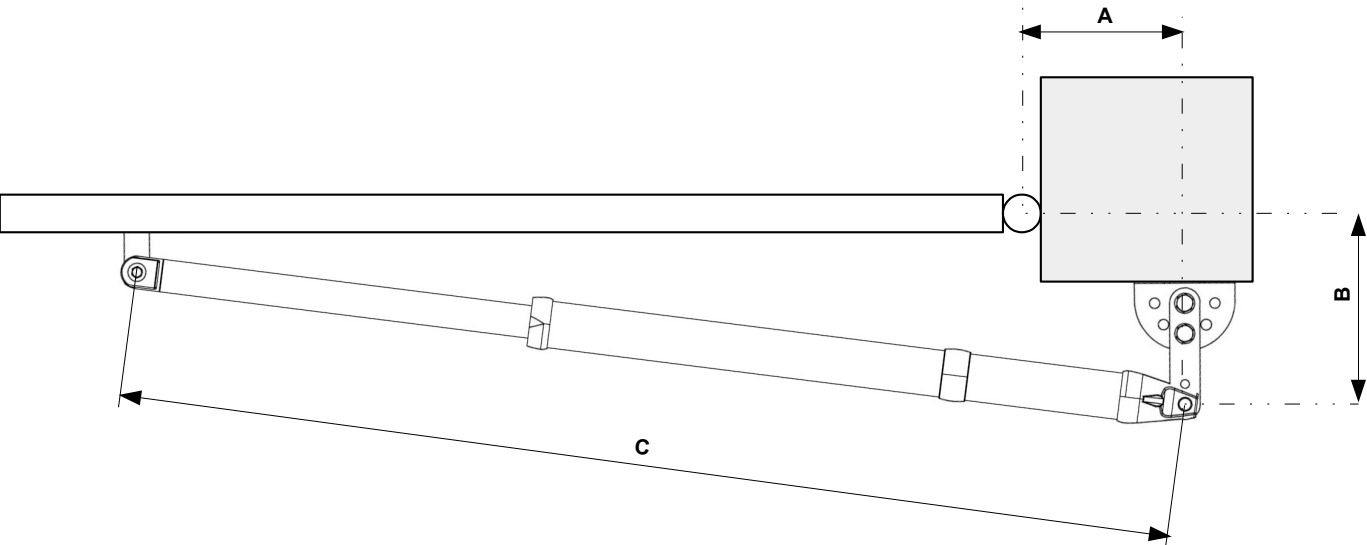

Dim	90°	120°
A	140	120
B	140	120
C	1000	1000

**Hint:** To reach suggested dimensions, is it possible to cut the rear support.

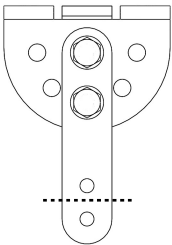

**Hint:** To let road enter or exit turn it as in the picture.

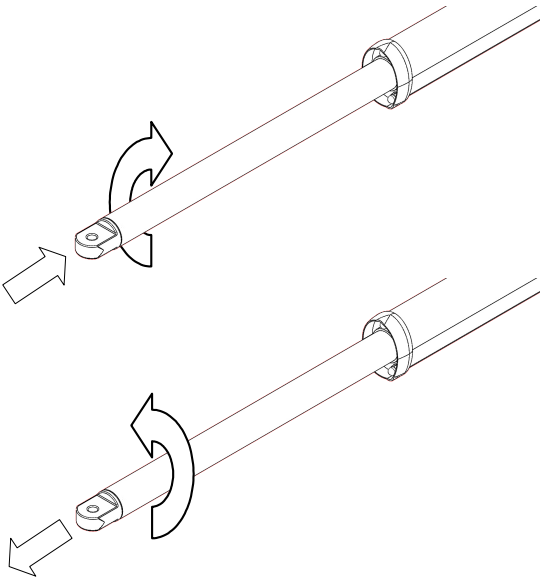

## Back support

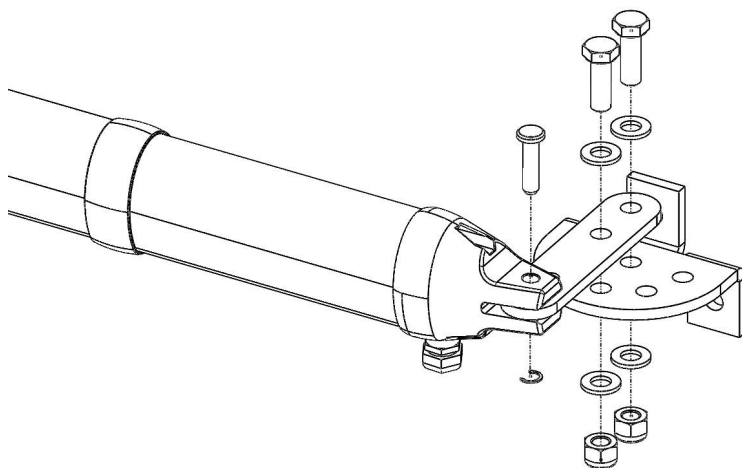

## Front support

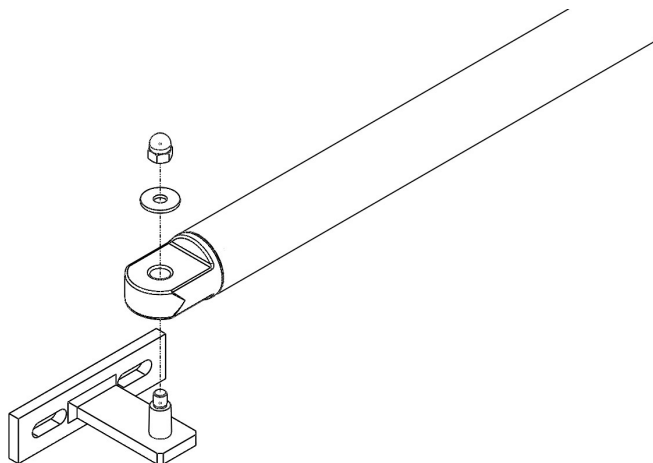

## Manual opening

GB

To manually open the actuator unscrew (1) and remove (2) the nut and the washer on the front support, then pull up the rod (3). **Warning:** keep hands far from support, since when rod is unlocked, the closing mechanical tension is discharged.

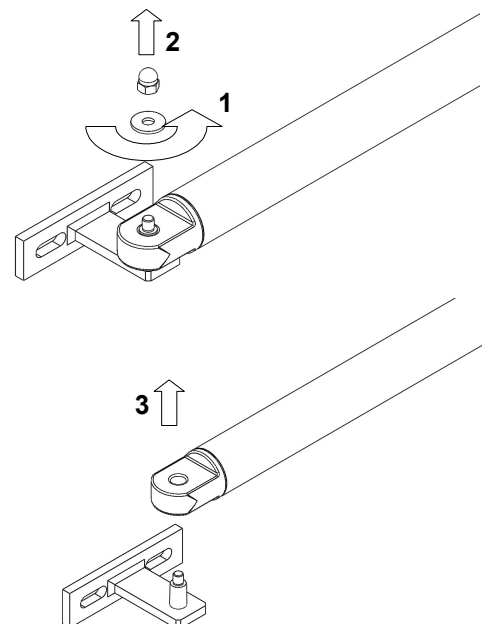

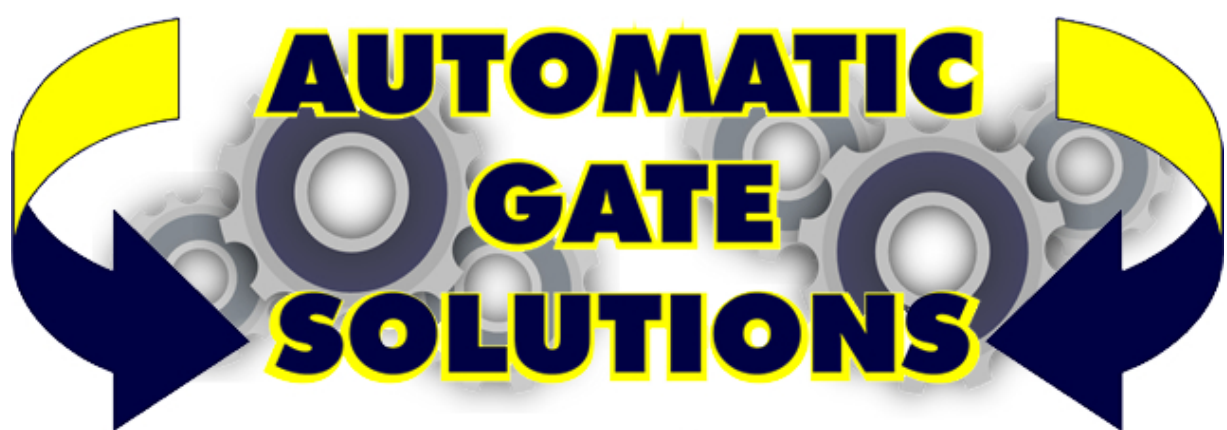

[www.automaticgatesolutions.com.au](http://www.automaticgatesolutions.com.au)